

## Specification parameters

Item	TS5D-1500-E2	TS5D-1500-4G	TS5D-1500-W
Product feature	Size	15.6"	
	Type	16.77 million colors	
	Resolution	1920*1080	
	Brightness	250 cd/m <sup>2</sup>	
	Touch panel	Four-wire resistive touch panel	
	Service life	Over 30000 hours, ambient temperature of 25°C, 24-hour operation	
	Processor	Cortex-A7 1.2GHz	
	Storage	256MB	
	Adaptive software	TouchwinPro software	
Interface	COM1	RS232/RS485	
	COM2	RS232/RS485/RS422	
	Ethernet port	Standard RJ45, 10/100M*2	
	USB port1	USB-A (compliant with USB2.0 specifications), 2 USB flash drive ports	
	USB port2	Type-C, USB download port	
	Audio	Ø3.5coaxial audio interface	
	4G	/	4G LTE-FDD (Mbps): 10 (downlink) / 5 (uplink)
WiFi	/	/	IEEE 802.11 a/b/g/n IEEE 802.11 g:54Mbps
Electrical feature	Input voltage	DC24V (voltage range: DC22V-DC26V)	
	Power	10W	
	Allowable instant power failure	Below 10ms (actual power loss less than 1s)	
	Withstand voltage	AC1000V, 10mA, less than 1 minute (signal to ground)	
Environment	Insulation impedance	DC500V, above 10MΩ (signal to ground)	
	Operation temperature	0-50°C	
	Storage temperature	-10-60°C	
	Environmental humidity	10%RH-90%RH (without condensation)	
	Vibration resistance	10-25Hz (2G in X, Y, and Z directions for 30 minutes each)	
	Anti-interference	Voltage noise: 1500Vp-p, pulse width 1us, 1 minute	
	Surrounding air	Non corrosive gas	
Structure	Protection level	Front panel Ip65	
	Cooling method	Natural air cooling	
	External dimension (mm)	396.0*259.0*39.0	
	Opening size (mm)	384.0*247.0 (±0.5)	

## Product dimension diagram (Unit: mm)

### TS5D-1500series

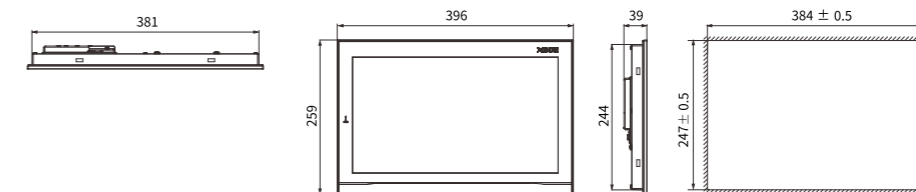

XINJE WeChat

## XINJE

WUXI XINJE ELECTRIC CO.,LTD.

Address: No.816 Jianzhu West Road, Binhu District, Wuxi City, Jiangsu Province, China

TEL: 0510-85134136

Fax: 0510-85111290

Website: www.xinje.com

E-mail: xinje@xinje.com

## TS5D series IoT metal HMI

Fearless of harsh environment and remote information exchange

Automation trusted partners

# TS5D series

## IoT Metal HMI

The TS5D series IoT HMI cleverly integrates the HMI with gateway products, through built-in 4G or WiFi communication modules, it not only has traditional HMI functions but also enables 4G or WiFi networking functions. The metal structure of the entire machine greatly enhances its heat dissipation and anti-interference capabilities, making it suitable for use in harsh on-site environments.



Higher performance,  
suitable for harsh scenarios

### Appearance

#### Ultra thin body

The thickness is only 39mm, saving installation space



#### Metal cover

Metal structure enhances overall anti-interference and heat dissipation

### Performance

#### Higher performance

ARM Cortex-A7 processor, main frequency 1.2GHz



#### Larger capacity

256MB memory, large capacity storage

### Function

#### Networking communication

- Support wired communication, optional wireless (WiFi or 4G) internet access, ensuring both communication and networking
- Cover mainstream information exchange protocols, support MQTT and TCP/IP communication

#### Multimedia

Support streaming media and preset video playback, with better performance when used in conjunction with audio

#### Real time monitoring

Support connecting network cameras for remote monitoring

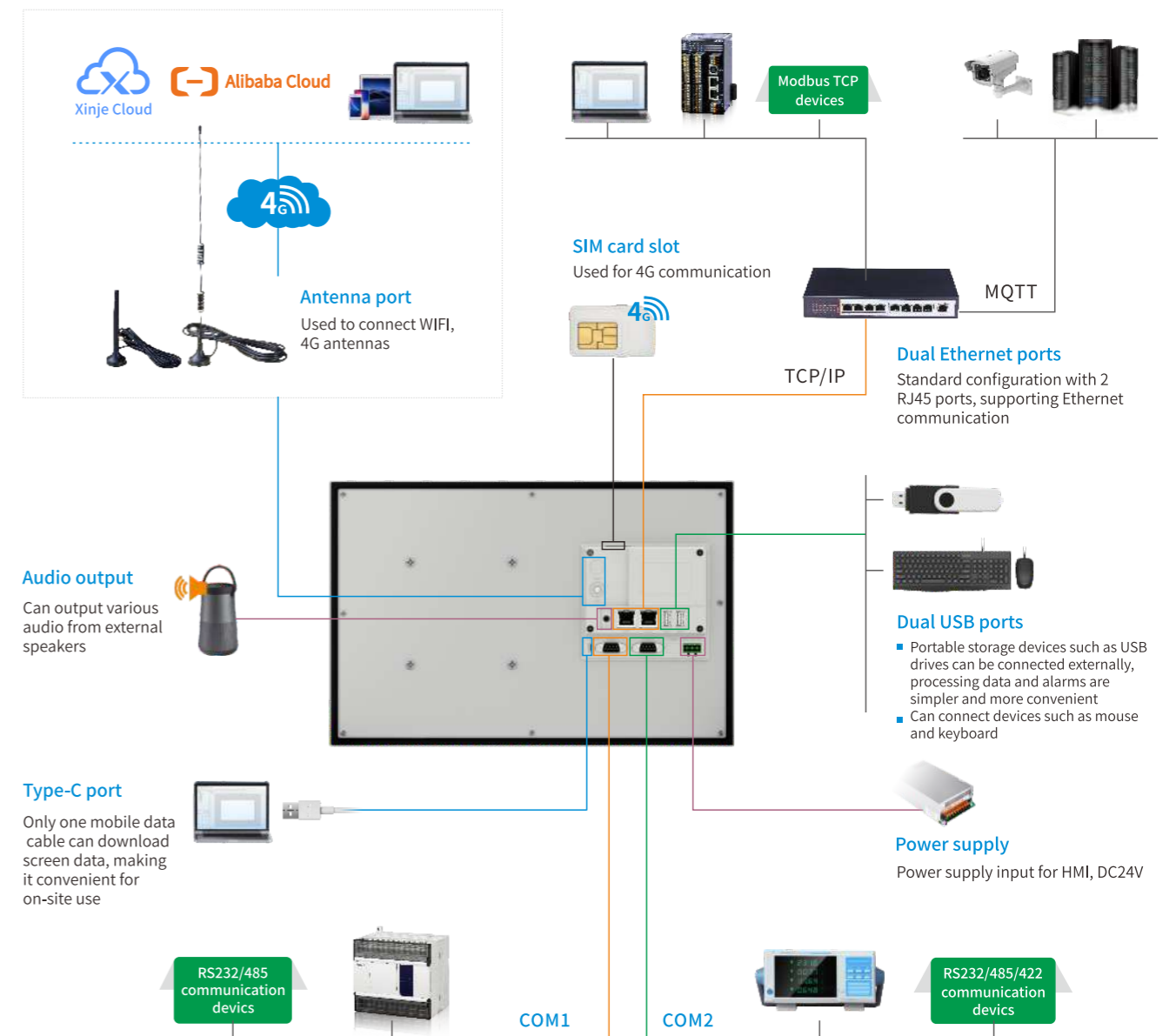

### Naming rule

TS5D - 1500 - E2

①                      ②                      ③

- ① Series name: TS5D series
- ② Display size: 1500: 15.6 inches

#### ③ Interface configuration

- E2: Equipped with Type-C port, USB-A port\*2, COM1, COM2, RJ45 port\*2, audio port
- 4G: Equipped with Type-C port, USB-A port\*2, COM1, COM2, RJ45 port\*2, audio port, SIM card slot, antenna port
- W: Equipped with Type-C port, USB-A port\*2, COM1, COM2, RJ45 port\*2, audio port, antenna port