

© Copyright 2017 ATEN® International Co., Ltd.
ATEN and the ATEN logo are trademarks of ATEN International Co., Ltd. All rights reserved. All other trademarks are the property of their respective owners.

Printing Date: 03/2017

A Hardware Review



Package Contents

- 1 VB800 True 4k HDMI Booster
- 1 Power Adapter
- 1 Rack Mount Kit
- 1 User Instructions

B Hardware Installation

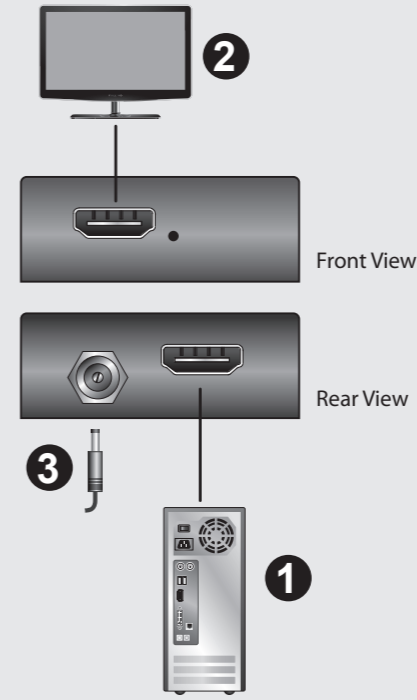

Support and Documentation Notice

All information, documentation, firmware, software utilities, and specifications contained in this package are subject to change without prior notification by the manufacturer.

To reduce the environmental impact of our products, ATEN documentation and software can be found online at

<http://www.aten.com/download/>

Technical Support

www.aten.com/support

Scan for more information



EMC Information

FEDERAL COMMUNICATIONS COMMISSION INTERFERENCE STATEMENT

This equipment has been tested and found to comply with the limits for a Class A digital device, pursuant to Part 15 of the FCC Rules. These limits are designed to provide reasonable protection against harmful interference when the equipment is operated in a commercial environment. This equipment generates, uses, and can radiate radio frequency energy and, if not installed and used in accordance with the instruction manual, may cause harmful interference to radio communications. Operation of this equipment in a residential area is likely to cause harmful interference in which case the user will be required to correct the interference at his own expense.

FCC Caution: Any changes or modifications not expressly approved by the party responsible for compliance could void the user's authority to operate this equipment.

Warning: Operation of this equipment in a residential environment could cause radio interference.

Warning: This equipment is compliant with Class A of CISPR 32. In a residential environment this equipment may cause radio interference.

This device complies with Part 15 of the FCC Rules. Operation is subject to the following two conditions: (1) this device may not cause harmful interference, and (2) this device must accept any interference received, including interference that may cause undesired operation.

이 기기는 업무용 (A급) 전자파적합기기로서 판매자 또는 사용자는 이 점을 주의하시기 바라며, 가정외의 지역에서 사용하는 것을 목적으로 합니다.

VB800 True 4k HDMI Booster

www.aten.com

A Hardware Review

Front View

- 1 HDMI In
- 2 Power Jack

Rear View

- 3 Power LED
- 4 HDMI Out

B Hardware Installation

- 1 Use a HDMI cable to connect the HDMI source device port to the Video input port on the VB800.
- 2 Use a HDMI cable to connect a HDMI display to the Video Output port on the VB800.
- 3 Plug the power adapter that came with the VB800 into a DC power source, and then plug the power adapter cable into the Power Jack.
* (If using a single VB800 the power adapter is not necessary, a single VB800 can be powered from the source device.)

Once the hardware installation is complete, the display is ready for use.

*Note

It is recommended to use the power adapter to rule out degraded performance.

Cascade

The VB800 can be cascaded up to 10 levels to make long distance 4k transmissions. Every third unit in a cascade needs to be connected to a power adapter.

Rack Mounting

The VB800 comes with a rack mount kit. To attach the VB800 to the rack please follow these steps:

1. Place the brackets into position onto the back of the VB800.
2. Use the screws to screw the brackets to the back of the VB800.

Booster HDMI True 4k VB800

www.aten.com

A Présentation du matériel

Vue de devant

- 1 Entrée HDMI
- 2 Fiche d'alimentation

Vue de derrière

- 3 LED d'alimentation
- 4 Sortie HDMI

B Installation du matériel

- 1 Utilisez un câble HDMI pour raccorder le port HDMI du périphérique source au port d'entrée vidéo du VB800.
- 2 Utilisez un câble HDMI pour raccorder un écran HDMI au port de sortie vidéo du VB800.
- 3 Branchez l'adaptateur secteur fourni avec le VB800 sur une source d'alimentation CC, puis branchez le câble de l'adaptateur d'alimentation sur la prise d'alimentation.
* (Si vous utiliser un seul VB800, l'adaptateur d'alimentation n'est pas nécessaire, un VB800 unique peut être alimenté depuis le périphérique source.)

Une fois l'installation matérielle terminée, l'affichage est prêt à l'utilisation.

*Remarque

Il est recommandé d'utiliser l'adaptateur d'alimentation pour éviter toute dégradation de performances.

Cascade

Le VB800 peut être mis en cascade jusqu'à 10 niveaux pour augmenter la distance de transmission 4k. Une unité sur trois en cascade doit être reliée à un adaptateur d'alimentation.

True-4K-HDMI-Verstärker VB800

www.aten.com

A Hardwareübersicht

Ansicht von vorne

- 1 HDMI-Eingang
- 2 Netzanschluss

Ansicht von hinten

- 3 Betriebsanzeige-LED
- 4 HDMI-Ausgang

B Hardwareinstallation

- 1 Verbinden Sie das HDMI-Eingangsgerät über ein HDMI-Kabel mit dem Videoeingang am VB800.
- 2 Verbinden Sie ein HDMI-Anzeigergerät über ein HDMI-Kabel mit dem Videoausgang am VB800.
- 3 Schließen Sie das mit dem VB800 gelieferte Netzteil an eine Gleichspannungsversorgung an, verbinden Sie dann das Netzteilkabel mit dem Netzanschluss.
* (Bei Verwendung eines einzelnen VB800 ist kein Netzteil erforderlich. Ein einzelner VB800 kann über das Eingangsgerät mit Strom versorgt werden.)

Sobald die Hardwareinstallation abgeschlossen ist, ist das Anzeigergerät einsatzbereit.

*Hinweis

Sie sollten das Netzteil verwenden, damit sich die Leistung nicht verringert.

Kaskadieren

Der VB800 kann zur 4K-Übertragung auf lange Strecken auf bis zu 10 Stufen kaskadiert werden. Jedes dritte Gerät in einer Kaskade muss mit einem Netzteil verbunden werden.

Rackmontage

Der VB800 kommt mit einem Rackmontageset. Befolgen Sie zur Anbringung des VB800 im Rack die nachstehenden Schritte:

1. Bringen Sie die Halterungen an der Rückseite des VB800 an.
2. Schrauben Sie die Halterungen an der Rückseite des VB800 fest.

Refuerzo HDMI 4k Real VB800

www.aten.com

A Revisión del hardware

Vista frontal

- 1 Entrada HDMI
- 2 Conector de alimentación

Vista posterior

- 3 LED de alimentación
- 4 Salida HDMI

B Instalación de hardware

- 1 Utilice un cable HDMI para conectar el puerto del dispositivo fuente HDMI al puerto de entrada de vídeo en el VB800.
- 2 Utilice un cable HDMI para conectar una pantalla HDMI al puerto de salida de vídeo en el VB800.
- 3 Enchufe el adaptador de alimentación suministrado con el VB800 en una fuente de alimentación CC, y a continuación, enchufe el cable del adaptador de alimentación en el conector de alimentación.
* (Si utiliza un único VB800, no es necesario el adaptador de alimentación; un único VB800 puede ser alimentado desde el dispositivo fuente.)

Una vez que se haya finalizada la instalación del hardware, la pantalla ya está lista para su uso.

*Nota

Se recomienda utilizar el adaptador de alimentación para eliminar la posibilidad de una merma en el rendimiento.

Cascada

El VB800 puede configurarse en una cascada de hasta 10 niveles para realizar transmisiones 4k de larga distancia. Cada tercera unidad en una cascada necesita estar conectada a un adaptador de alimentación.

Montaje en bastidor

El VB800 viene con un kit de montaje en bastidor. Para fijar el VB800 al bastidor, siga los pasos a continuación:

1. Coloque los soportes en su posición en la parte posterior del VB800.
2. Utilice los tornillos para asegurar los soportes a la parte posterior del VB800.

Amplificatore HDMI True 4k VB800

www.aten.com

A Descrizione hardware

Vista anteriore

- 1 Ingresso HDMI
- 2 Connettore di alimentazione

Vista posteriore

- 3 LED alimentazione
- 4 Uscita HDMI

B Installazione dell'hardware

- 1 Utilizzare un cavo HDMI per collegare la porta del dispositivo sorgente HDMI alla porta di ingresso Video su VB800.
- 2 Utilizzare un cavo HDMI per collegare un display HDMI alla porta di uscita Video su VB800.
- 3 Collegare l'adattatore di alimentazione in dotazione con VB800 ad una presa di corrente CC, quindi collegare il cavo dell'adattatore di alimentazione al connettore di alimentazione.
* (Se si utilizza un singolo VB800, l'adattatore di alimentazione non è necessario; è possibile alimentare un singolo VB800 dal dispositivo sorgente.)

Al termine dell'installazione dell'hardware, il display è pronto per l'uso.

*Nota

Si consiglia di utilizzare l'adattatore di alimentazione per escludere un decadimento delle prestazioni.

Collegamento a cascata

VB800 può essere collegato a cascata fino a 10 livelli per ottenere trasmissioni 4k a lunga distanza. Ogni tre unità collegate a cascata è necessario effettuare il collegamento ad un adattatore di alimentazione.

Montaggio su rack

VB800 dispone di un kit di montaggio su rack. Per fissare VB800 al rack, effettuare le seguenti procedure:

1. Collocare le staffe in posizione sul retro di VB800.
2. Utilizzare le viti per avvitare le staffe sul retro di VB800.

