

USB DVI Dual View HDBaseT™ 2.0 KVM Extender (1920 x 1200 @100 m) CE624

- The ATEN CE624 USB DVI Dual View HDBaseT™ 2.0 KVM Extender integrates the latest HDBaseT™ 2.0 technologies to provide the most reliable transmission of video, audio, USB and RS-232 signals available on the market. The CE624 delivers high-quality DVI Dual View video, PCM 2-channel digital audio, USB 2.0 and RS-232 signals up to 100 meters from the source computer using a single Cat6/6a cable. With a simple cable installation supporting various signals, the CE624 is ideal for applications where convenient remote access is required – in places such as transportation control centers, medical facilities, industrial warehouses and extended workstations.

 Extension
100 m

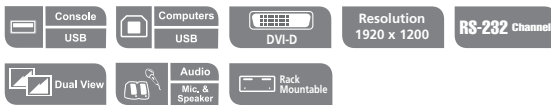

Features

- Allows DVI Dual View access to a computer and KVM control from a remote console
- HDBaseT™ 2.0 connectivity technology
 - Extends video, audio, USB and RS-232 signals via a single Cat6/6a cable
 - EDID Buffer for smooth power-up and the highest quality display
 - Enhanced bit error detection and correction to resist signal interference during high-quality video transmissions
- Long distance superior video quality
 - HDBaseT™ Standard mode up to 1920 x 1200 @ 100 m
 - HDBaseT™ Long Reach mode up to 1920 x 1080 @ 150 m
- Long Reach mode switch — switches between HDBaseT™ Standard and Long Reach modes in a snap
- Integrated USB 2.0 ports — ensuring fast transmission speeds for keyboard, mouse and peripherals
- Supports 2-channel PCM digital audio — ensuring high-quality audio transmissions
- Supports PC Wakeup function via pushbutton or hotkey
- Built-in 8KV/15KV ESD protection (Contact voltage 8KV; Air voltage 15KV)
- HDCP 2.2 compatible

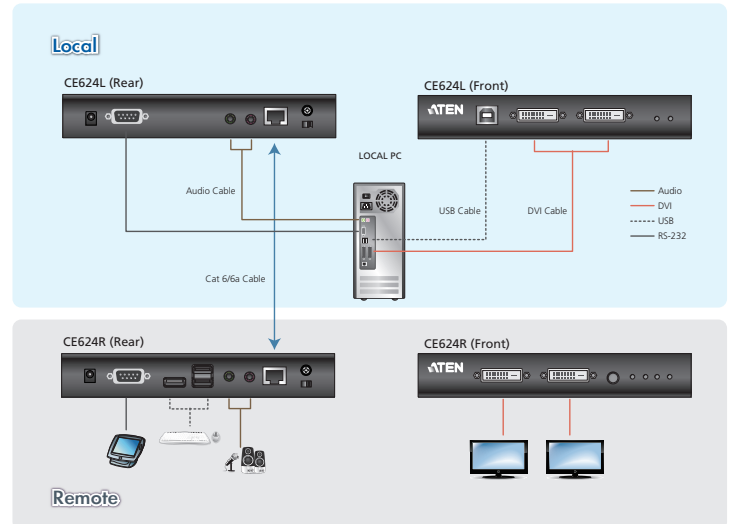

Specifications

| Function | CE624L | CE624R |
|----------------------------|--|--|
| Connectors | | |
| Console Ports | N/A | 2 x DVI-D Female (White) 3 x USB Type A Female (White) 1 x Mini Stereo Jack Female (Green) 1 x Mini Stereo Jack Female (Pink) |
| KVM Ports | 2 x DVI-D Female (White) 1 x USB Type B Female (White) 1 x Mini Stereo Jack Female (Green) 1 x Mini Stereo Jack Female (Pink) | N/A |
| RS-232 | 1 x DB-9 Female (Black) | 1 x DB-9 Male (Black) |
| Power | 1 x DC Jack with locking | 1 x DC Jack with locking |
| Sub / Main | 1 x RJ-45 Female (Black) | 1 x RJ-45 Female (Black) |
| LEDs | | |
| Link | 1 (Green) | 1 (Green) |
| Power | 1 (Orange) | 1 (Orange) |
| Video Output | N/A | 2 (Orange) |
| Switches | | |
| Long Reach Mode Switch | 1 x Slide Switch | 1 x Slide Switch |
| Firmware Upgrade | 1 x Slide Switch | 1 x Slide Switch |
| Pushbuttons | | |
| Wakeup button | N/A | 1 x Push button |
| Video | Up to 1600 x 1200 & 1920 x 1200 @ 90 m (Cat 5e) / 100 m (cat 6/6a) | Up to 1600 x 1200 & 1920 x 1200 @ 90 m (Cat 5e) / 100 m (cat 6/6a) |
| | 1080P @ 100 m | 1080P @ 100 m |
| Power Consumption | DC 5 V, 5.5 W | DC 5 V, 12.2 W |
| Environmental | | |
| Operating Temperature | 0° to 40° C | 0° to 40° C |
| Storage Temperature | - 20° to 60° C | - 20° to 60° C |
| Humidity | 0 - 80% RH, Non-condensing | 0 - 80% RH, Non-condensing |
| Physical Properties | | |
| Housing | Metal | Metal |
| Weight | 1.61 kg | 1.61 kg |
| Dimensions (L x W x H) | 17.42 x 15.94 x 2.88 cm | 17.42 x 15.94 x 2.88 cm |

ATEN International Co., Ltd.

3F., No.125, Sec. 2, Datong Rd., Sijhih District., New Taipei City 221, Taiwan
 Phone: 886-2-8692-6789 Fax: 886-2-8692-6767
 www.aten.com E-mail: marketing@aten.com

Publish Date: 12 / 2016 V1.0



© Copyright 2016 ATEN® International Co., Ltd.
 ATEN and the ATEN logo are trademarks of ATEN International Co., Ltd.
 All rights reserved. All other trademarks are the property of their respective owners.