

# TMS-Trigger Module

## TMS-trigger module



### » Overview

TMS-trigger module is specifically designed for SICOM3028GPT series which support PTP protocol. This module works as a part of TMS(Time Management System), provide accurate trigger and response, it realizes the real-time monitoring to the synchronization condition of various devices in the network.

### » Key Features

Designed for the SICOM3028GPT-L2GT,SICOM3028GPT-L2FT,SICOM3028GPT-L3GT,SICOM3028GPT-L3FT and managed by the chassis

Internal time synchronized as PTP slave with the chassis

Supports GOOSE publish and MMS report

Supports optical/electrical signal input/output

Supports hot-swap for easy maintenance (only can replace the same type of module)

### » Product Specifications

#### >Product Specifications -Standard

IEEE1588-2008(PTPv2)

IEC61850-8-1(GOOSE and MMS)

**-Interface**

IRIG-B port: IRIG-B DC input/output, TTL, 4-pin 3.81mm-spacing plug-in terminal block

Electrical signal input: Pulse, VDC110/220, 2-pin 3.81mm-spacing plug-in terminal block

Electrical signal output: Pulse, 2-pin 3.81mm-spacing plug-in terminal block

Optical signal input: Pulse, multi-mode SC connector

Optical signal output: Pulse, multi-mode SC connector

Console port: RS232,RJ45

**-LED**

Running LED: Run

Power LED: PWR

Electrical signal output LED: DO1

Electrical signal input LED: DI1

Optical signal output LED: DO2

Optical signal input LED: DI2

**-Power Requirements**

Power input: 3.3VDC

Power terminal: A type interface (powered by backplane)

Power consumption: <1.5W

**-Physical Characteristics**

Housing: Metal

Cooling: Natural cooling, fanless

Dimensions(WxHxD): 122mm×41mm×106.6mm(4.80×1.61×4.20 in.)

Weight: 0.5Kg (1.102 pound)

**-Environmental limits**

Operating temperature: -20°C to +85°C (-4°F to 185°F)

Storage temperature: -40°C to +85°C (-40°F to 185°F)

Ambient Relative Humidity: 5% to 95% (non-condensing)

**-Quality assurance**

Warranty: 5 years

## » Mechanical Drawing

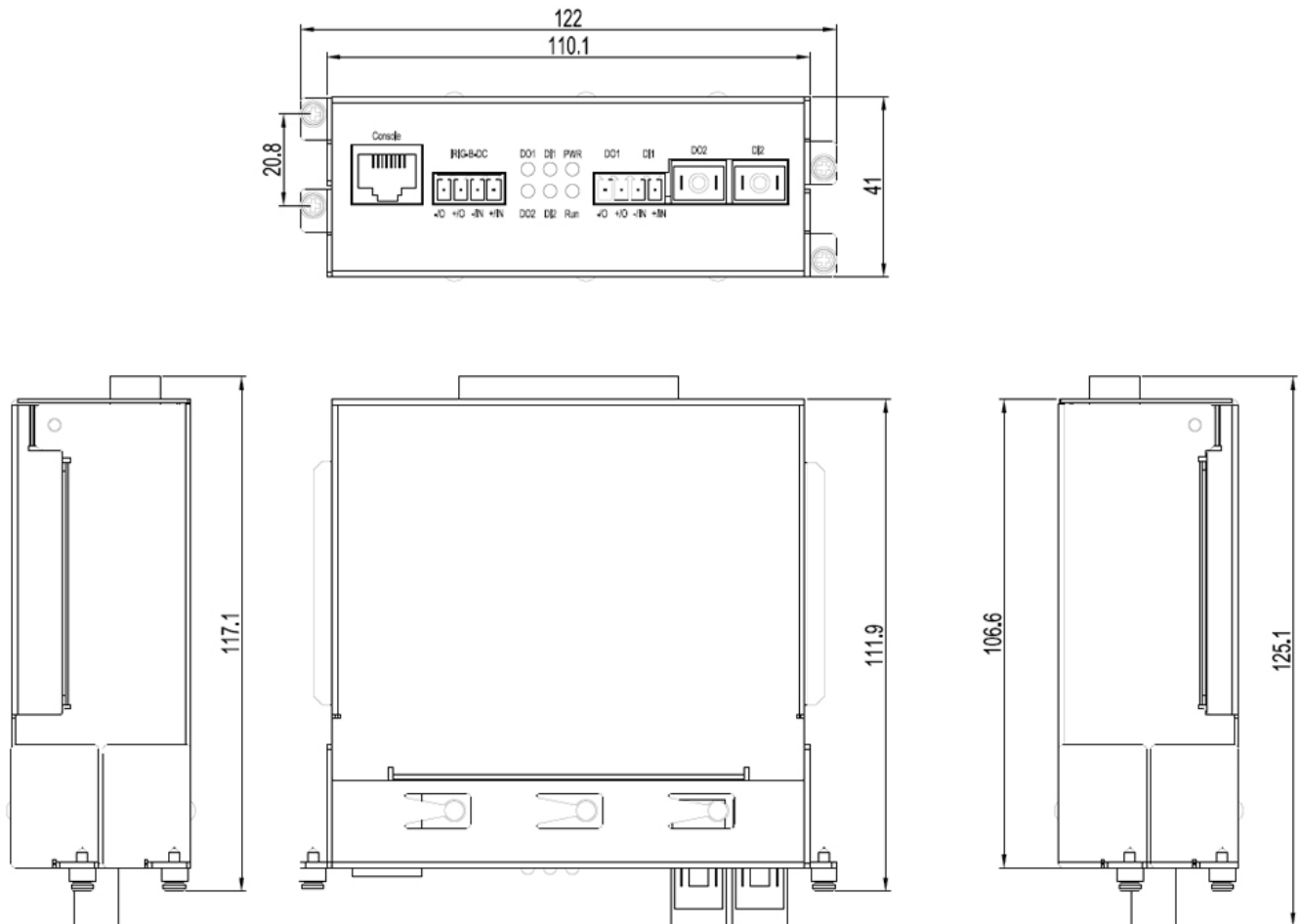

## » Ordering Information

**SM6.6-TMS-Trigger-1U:** TMS-trigger module, 1 IRIG-B output, 1 IRIG-B input, 2 signal input, 2 signal output, 1 Console port

Version:2020-03-23 14:11:39