

KIEN3016A

16 port unmanaged DIN-Rail switches



» Overview

The KIEN3016A series are Kyland Green Ethernet series, offering up to 16 Fast Ethernet ports, plug and play. The solid metal housing with IP40 protection class, strong vibration-resistant mounting clip for DIN-Rail installation, wide operating temperature range from -40°C to 85°C, and excellent EMC performance give the switches a stable and reliable operating capability in the harsh industrial environments, and make them ideal for setting up robust Fast Ethernet connection in power, ITS, factory automation, video surveillance and other industrial applications.

» Key Features

- 2 Fast Ethernet fiber/RJ45 optional ports, 14 10/100Base-T(X) ports
- EMC performance reaches industrial level 4
- IP40 protection class
- UL508, Class I Div 2, CE, FCC certificates

» Product Specifications

> Technical Specification

-Standard

IEEE 802.3i (10Base-T)

IEEE 802.3u (100Base-TX and 100Base-FX)

-Switch Properties

MAC Table: 8K

Packet Buffer: 2Mbit

Packet Forwarding Rate: 2.4Mpps

Switching Delay: <10 μ s

-Interface

Fast Ethernet Port:

100Base-FX, SM/MM, SC/ST/FC connector

10/100Base-T(X), RJ45 port

-LED

LEDs on Front Panel

Power LED: PWR1, PWR2

Interface LED: Link/ACT, Speed (RJ45 port); Link/ACT (Fiber port)

-Power Requirements

Power Input:

24-48VDC

12-24VDC

Power Terminal:

5-pin 5.08mm-spacing plug-in terminal block

Power Consumption: <12w

Overload Protection: Support

Reverse Protection: Support

Redundancy Protection: Support

-Physical Characteristics

Housing: Metal

Cooling: Mode Natural cooling, fanless

Protection Class: IP40

Dimension: 88mm \times 135mm \times 137mm(W \times H \times D)

Weight: 1.2Kg

Mounting: DIN-Rail or Panel Mounting

-Environmental Limits

Operating Temperature: -40 $^{\circ}$ C to +85 $^{\circ}$ C

Storage Temperature: -40°C to +85°C

Ambient Relative Humidity: 5-95% (non-condensing)

-Quality Assurance

MTBF: 361,000 hrs

Warranty: 5 years

-Approvals

UL508, Class I Div 2, CE(EMC), FCC: Models with L2:24-48VDC

-Industry Standard

EMI:

FCC CFR47 Part 15, EN55022/CISPR22, Class A

EMS:

IEC61000-4-2(ESD) ±8kV(contact), ±15kV(air)

IEC61000-4-3(RS) 10V/m(80MHz–2GHz)

IEC61000-4-4(EFT) Power Port: ±4kV; Data Port: ±2kV

IEC61000-4-5(Surge) Power Port: ±2kV/DM, ±4kV/CM; Data Port: ±2kV

IEC61000-4-6(CS) 10V(150kHz–80MHz)

Machinery:

IEC60068-2-6(Vibration)

IEC60068-2-27(Shock)

IEC60068-2-32(Free Fall)

» Mechanical Drawing

DIN Rail Mounting

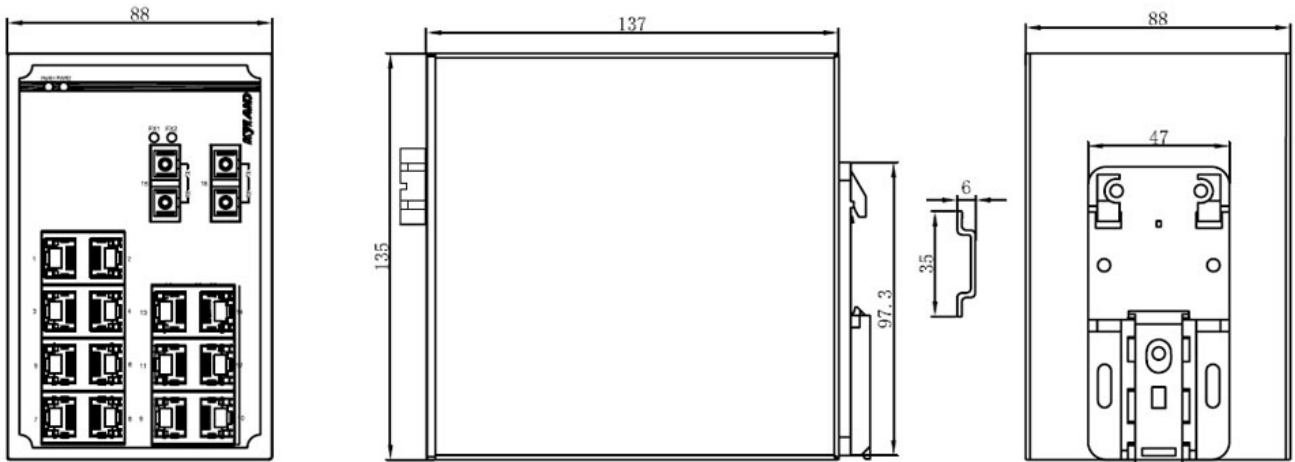

Panel Mounting

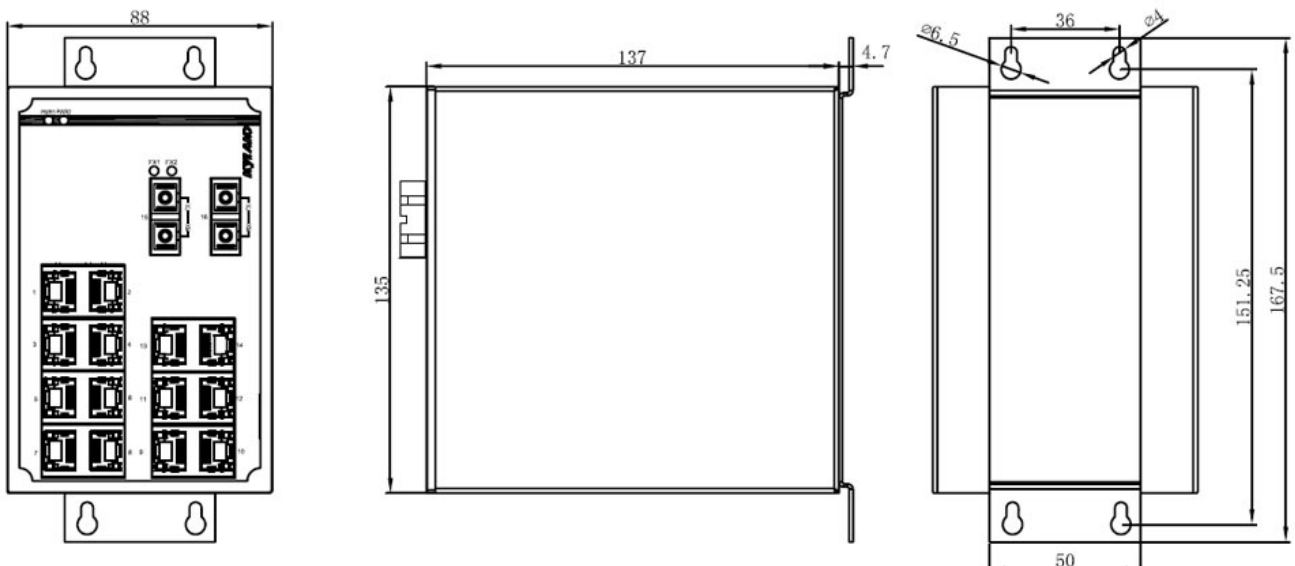

» Ordering Information

KIEN3016A-Ports-Connector-PS1-PS2

Ports

2S14T

2x100Base-FX, single mode fiber ports; 14x10/100Base-T(X) RJ45 ports

2M14T

2x100Base-FX, multi mode fiber ports; 14x10/100Base-T(X) RJ45 ports

16T	16X10/100Base-T(X) RJ45 ports
Connector	100M fiber port specifications
SC05	SC connector, multi-mode, 1310nm, 5km
ST05	ST connector, multi-mode, 1310nm, 5km
FC05	FC connector, multi-mode, 1310nm, 5km
SC40	SC connector, single-mode, 1310nm, 40km
ST40	ST connector, single-mode, 1310nm, 40km
FC40	FC connector, single-mode, 1310nm, 40km
SC60	SC connector, single-mode, 1310nm, 60km
SC80	SC connector, single-mode, 1550nm, 80km
None	No 100M fiber port
PS	
L2-L2	24-48VDC, redundant power inputs
L5-L5	12-24VDC, redundant power inputs
Accessories	
DT-BGAZ-02	Panel for Panel mounting
DT-FCZ-RJ45-01	Dustproof cover for RJ45 port

Version:2020-05-13 17:20:32